

NOTE:

All 38 1/4" units shown in this layout can be replaced with any available standard length case

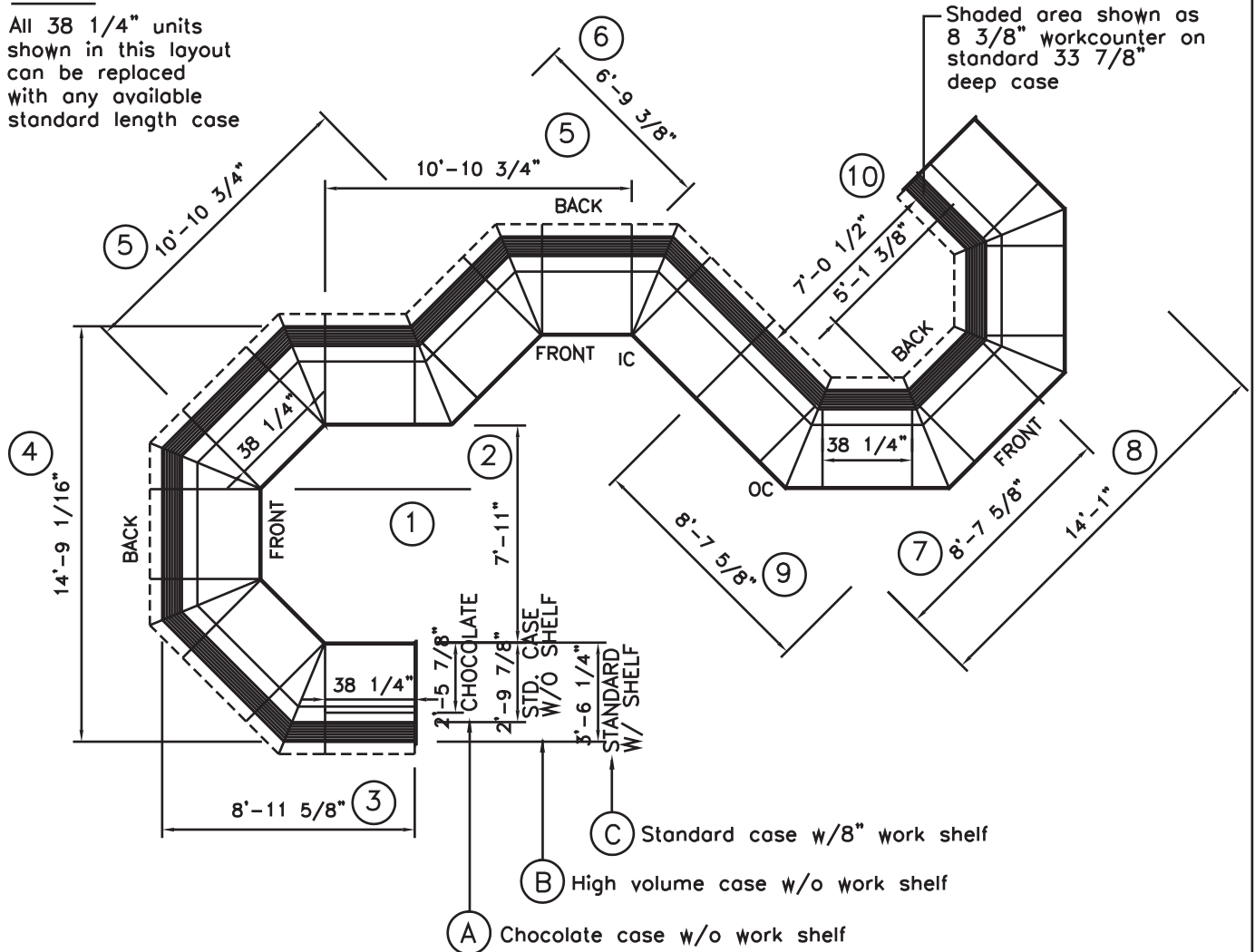

- | | |
|---|--|
| (1) Smallest 90° inside corner measured at front | (6) Smallest 2 X 45° dog leg measured depth |
| (2) Smallest 180° inside corner measured at front | (7) Smallest 90° outside corner measured at front |
| (3) Smallest 90° inside corner measured at back | (8) Smallest 180° outside corner measured at front |
| (4) Smallest 180° inside corner measured at back | (9) Smallest 90° outside corner measured at front |
| (5) Smallest 2 X 45° dog leg measured length | (10) Smallest 180° outside corner measured at back |